

INSTALLATION INSTRUCTIONS FOR OP2000 SERIES NON-WEATHERIZED, MORTISE LOCKSETS USING FALCON™ LM SERIES LOCKS (LEVER)

WARNING: THIS PRODUCT IS NOT WARRANTED FOR OUTDOORS USE!
NOTE: A DOOR-CLOSER IS HIGHLY RECOMMENDED FOR USE WITH THIS PRODUCT.

THIS PRODUCT IS NORMALLY FACTORY-PACKED FOR RIGHT-HAND 1-3/4" TO 2" THICK DOORS. TO CHANGE HAND OF LOCK, SEE INSTRUCTION SECTION 2

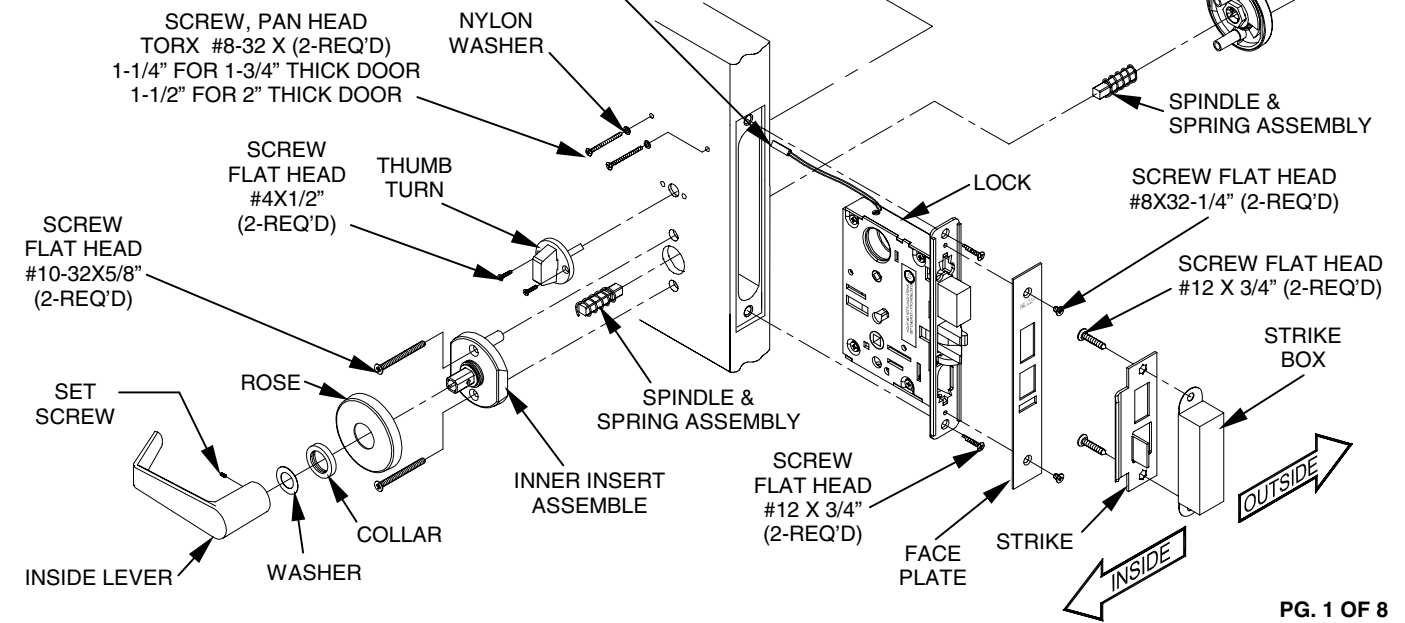
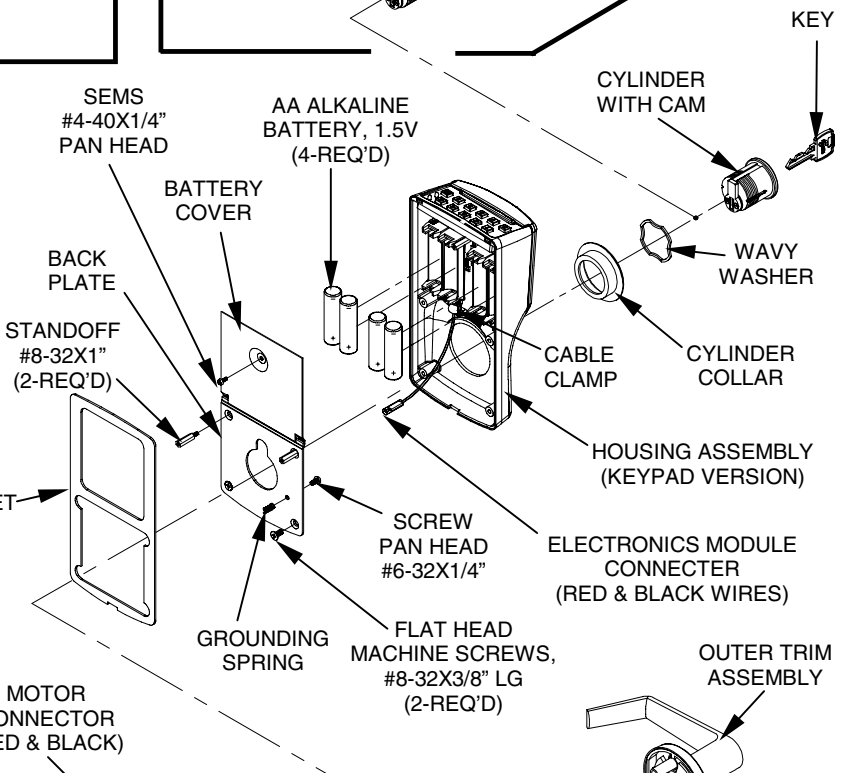
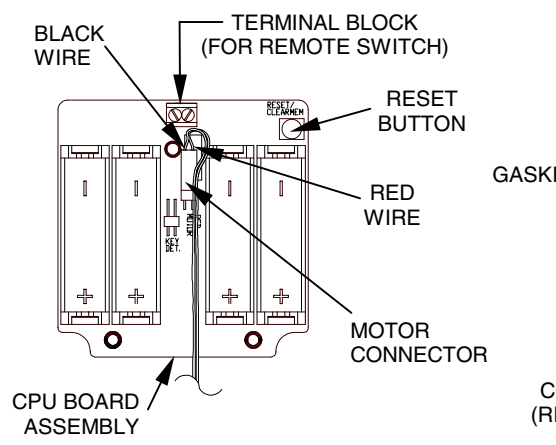
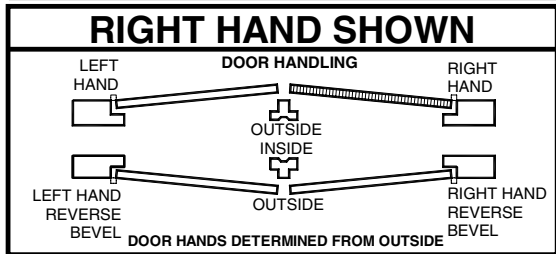
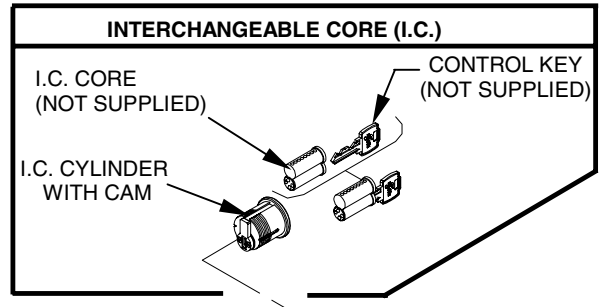

SECTION 1: CHECK OPERATION

- a. Connect the Motor Connector from the lock to the Electronic Module Connector so that the red wires are aligned.
- b. Verify proper operation of the System using the Default Programmer ID Proximity card. Momentarily place the center of the Proximity Card (Included in the OMNILOCK Administrator's Kit) over the recess in the front of the OP2000. The System will flash green once and unlock, then, during the Open Delay Time, it will flash green five times. The System will flash red and lock. While unlocked, check for proper operation of the lock.
- c. If your System has a Keypad Proceed as follows, otherwise go to Section 2: Verify proper operation of the System using the Keypad. Enter the Default Programmer ID, **1 2 3 4**, at the Keypad. The Lights will flash as in the previous step.
- d. If the System malfunctions remove the Battery Cover and check for proper orientation and seating of the Batteries and Motor Connector. Ensure that the wires are not pinched. Reset the electronics by pressing and holding the Reset Button on the circuit board until the light flashes green, approximately three seconds. The System will go through a self-test and flash green 5 times. Any red flash indicates an electronics or motor problem. Repeat the verification process if all flashes are green.

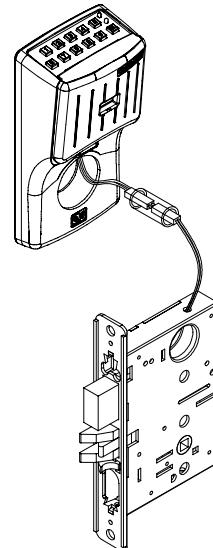

SECTION 2: ADJUST THE LOCK HAND

2-1 This section is only required if the lock hand, as received, does not meet your requirements. The Lock is normally preset for a right hand door. Verify the hand of the Lock and, if required, change the hand of the Lock as follows, after checking per Section 1. Refer to Fig. 2-1.

NOTE: If the Lock has a Dead Bolt, it must be in the retracted position when reversing hand.

a. REMOVE COVER

1. Remove the four Cover Retaining Screws and slowly remove the Cover from the Case.

b. REVERSE LATCH BOLT ASSEMBLY

1. Lift out the Cylinder Retract Lever, if included.
2. Lift out the Upper Retract Arm, if included.
3. Compress the Latch Bolt Spring toward the Face Plate to clear the Latch Bolt Guide Seat. Lift out and invert the Latch Bolt Assembly. Place the Latch Bolt Spring into the Latch Bolt Guide Seat.

NOTE: Lower Retract Arm (below the Upper Retract Arm) must be between the Latch Bolt Foot and the Latch Bolt Guide.

c. REVERSE HUBS

1. To reverse, pull the Coupling toward the rear of the Case.
2. Lift out both Hubs together, invert as an assembly and replace.
3. Ease the Coupling back against the Hubs.

d. REASSEMBLE RETRACT ARM AND LEVER

1. Replace the Upper Retract Arm so that the Arm fits into the space between the Latch Bolt Foot and the Coupling.
2. Replace the Cylinder Retract Lever so that it straddles the Dead Bolt Pin.
3. Replace the Cover guiding the "T" Turn Hub into the Cover hole. Depress the Latch Bolt to clear the Foot.

NOTE: A Phillips head screwdriver inserted through the Cover into the "T" Turn Hub will retain the Hub and Cylinder Retract Lever in proper location while replacing the Cover.

e. REPLACE THE COVER RETAINING SCREWS.

f. REVERSE DEADLOCKING BAR

1. Remove the Face Plate. Remove the Deadlocking Bar, reverse it and replace it back into the Assembly. (Push against Blocker Assembly to allow Deadlocking Bar to be easily inserted)
2. Replace the Face Plate.

NOTE: The Concave Face of the Deadlocking Bar must be on the same side of the Door as the Beveled Face on the Latch Bolt. If this condition is not met, the Latch Bolt will be blocked from being able to be depressed as it comes into contact with the Strike.

LOCK ASSEMBLY

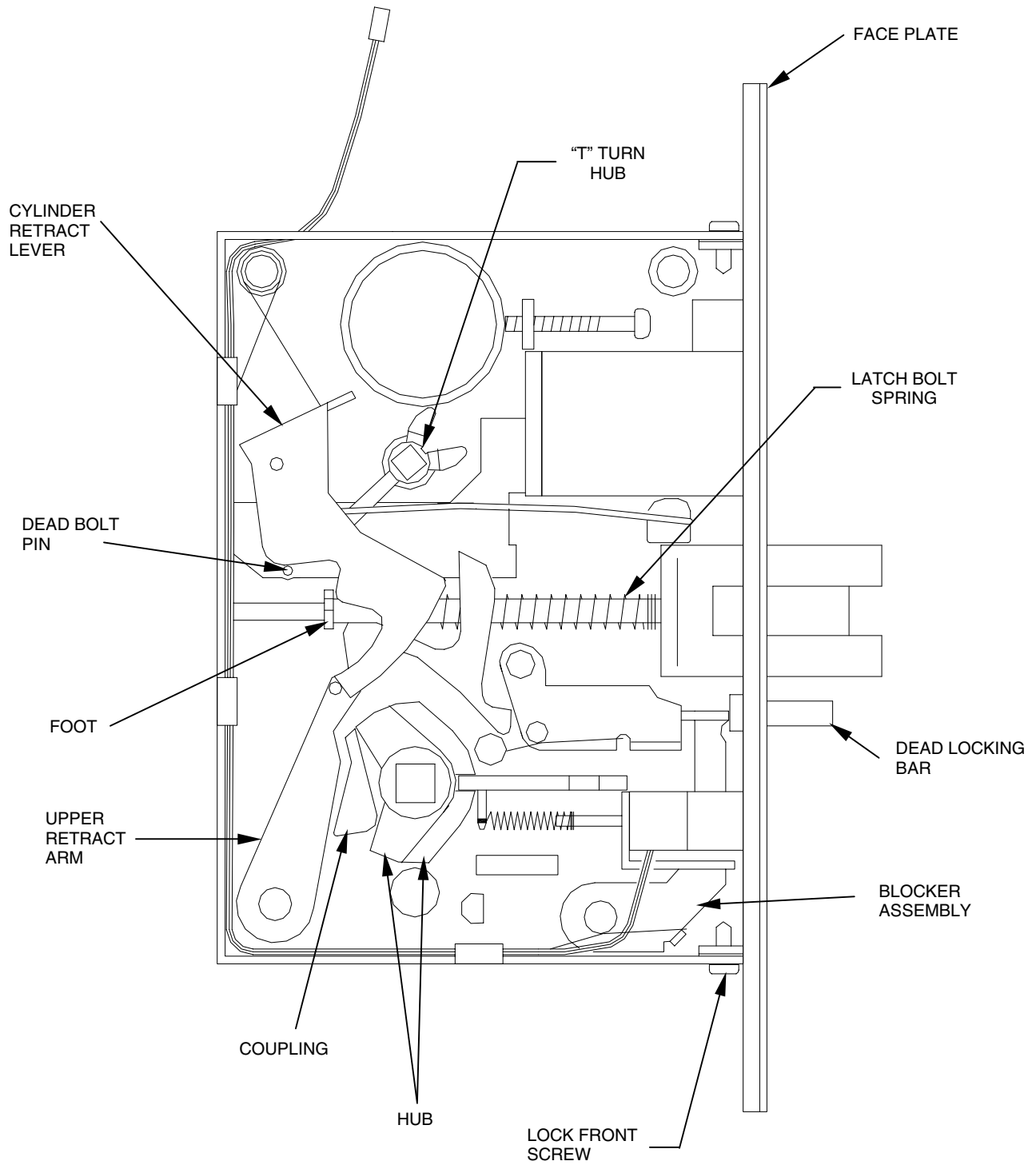

FIG.2-1

2-2 REVERSE HANDLE RETURN SPRING

Example shown is a right hand being changed to a left hand. Reverse the sequence to change from a left hand to a right hand.

Note: Inside Trim is always opposite the Outside Trim.

LH/LHR

RH/RHR



LEVER/HANDLE VIEW FROM OUTSIDE

- a. Holding the Lever as shown, bend the Tab of the Lock Washer back flat. Remove the Nut.

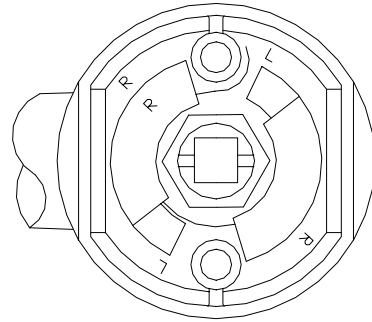

- b. Holding the Lever securely, rotate the Rose Assembly clockwise slightly and remove the Plate and Lock Washer.

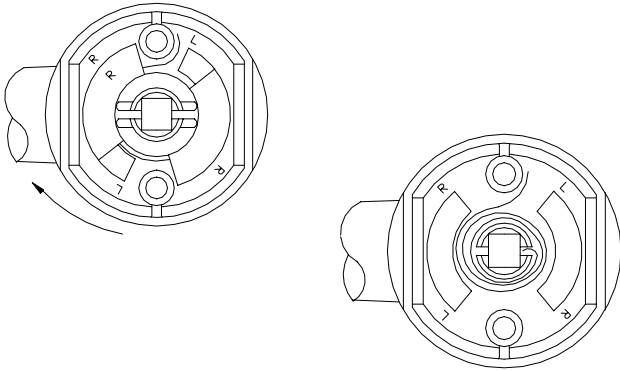

- c. Using caution, allow the Rose Assembly to rotate counterclockwise to relieve Spring Tension.

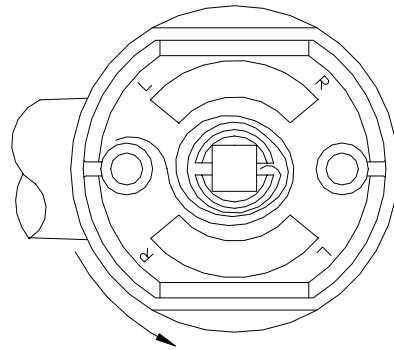

- d. Remove the Spring and reinstall with the Spring Hook on the opposite side of the Post.

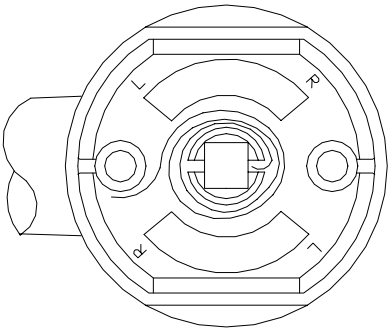

- e. Holding the Lever securely, rotate the Rose Assembly counterclockwise slightly past 90°.

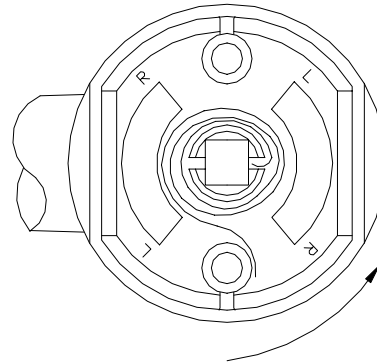

- f. Reinstall the Plate with the "L" side up and in Line with the "L" on the Rose Assembly.

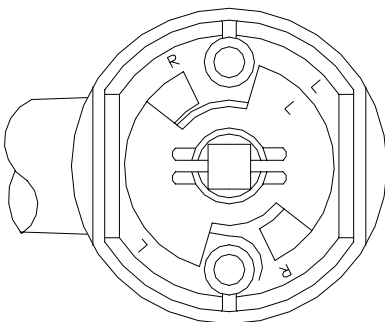

- g. Reinstall the Lock Washer and the Nut. Tighten the Nut and then back off slightly until the Rose Assembly rotates freely under the Plate. Bend up one Tab of the Lock Washer against the Nut.

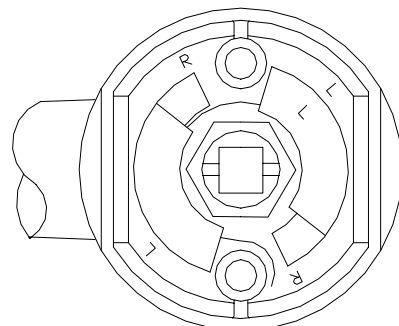

SECTION 3: PREPARE THE DOOR

3-1

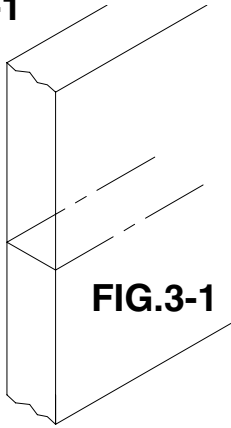

FIG.3-1

- a. Draw a horizontal centerline on both sides and edge of the Door at the desired Knob Center Height. Refer to Fig. 3-1.

NOTE: If the Frame has already been prepared for a Falcon Strike. Install the Strike and use the Strike Lip as a reference to locate the horizontal centerline position. Mark the Door $\frac{3}{16}$ " below the bottom of the Strike Lip as illustrated in Fig. 3-2 and draw horizontal centerlines on the Door at this position as illustrated in Fig. 3-1.

- b. Using the Backset Locator furnished, mark two points on each side of the Door, above and below the horizontal line. Refer to Fig. 3-3 Draw a vertical line through the two points on each side of the Door.
- c. Separate the Door Edge Template from the Door Surface Template. Position the correct side of the Door Surface Template on the outside face of the Door, aligning the Locator points with the horizontal and vertical lines drawn on the Door as illustrated in Fig. 3-4.

CAUTION: Spot only those holes required for the Lockset being installed, and mark the Strike Lip position on the Frame.

- d. Using the opposite side of the Template, position on the inside face of the Door aligning locator points with the horizontal and vertical lines drawn on the Door and spot the required holes.
- e. Center the Door Edge portion of the Template on the Door edge and align the horizontal Locator points with the horizontal line drawn on the Door. Mark the top and bottom points of the Case Mortise and the Face Plate top reference as illustrated in Fig. 3-5.

LOCATING POSITION OF HORIZONTAL CENTERLINE WHEN FRAME HAS BEEN PREPARED FOR STRIKE

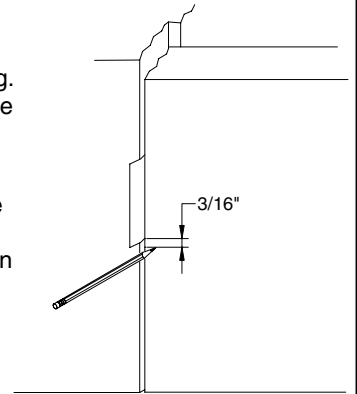

FIG.3-2

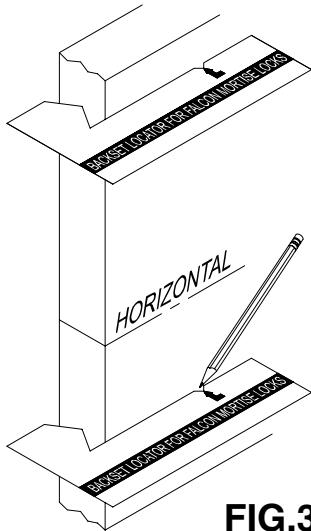

FIG.3-3

LOCATING VERTICAL ϕ

MARK FACE PLATE TOP REFERENCE

FIG.3-5

MARK STRIKE LIP POSITION ON FRAME. NOTE: BOTTOM OF LIP IS $\frac{3}{16}$ " ABOVE HORIZONTAL ϕ

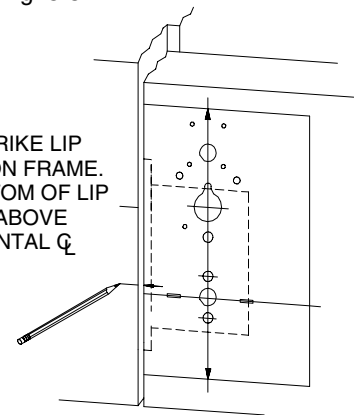

FIG.3-4

3-2

- b. Mortise the Door edge for the Lock Case to the dimensions shown on the Template. Insert the Lock (with Face Plate) in Mortise.

CAUTION: Do not pinch the Motor Wires

- b. Align the top of the Face Plate with the reference mark and scribe the Face Plate outline. Mortise to the front thickness.

- c. Drill the required side holes through the outside and inside faces of the Door.

CAUTION: Drill the holes only halfway through the Door from each side.

ALIGN WITH REFERENCE MARK

SCRIBE FACE OUTLINE

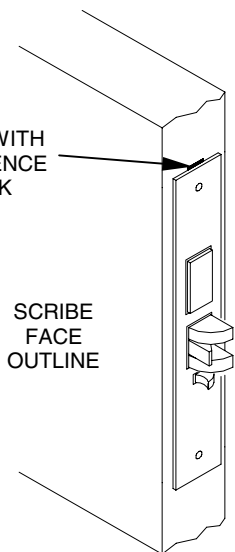

SECTION 4: INSTALL THE LOCK

4-1

- Remove the Face Plate and guide the Connector and the Lock into Mortise so that the Cable passes through the slot above the Cylinder hole and the Lock is seated in the Mortise.

CAUTION: Do not pinch the Cable.

- Mark the hole location for the Case Attachment Screws and remove the Lock from the Mortise. For Wood Doors, drill 1/8" dia. pilot holes for Case Attachment Screws, and counter drill the holes 7/32" dia. x 3/16" deep for Combination Screws. For Metal Doors, drill 3/16" dia. holes. Adjust the Front Bevel as required by loosening the Screws at the top and bottom of the Case, set the Bevel and securely re-tighten the Screws. Install the Lock.

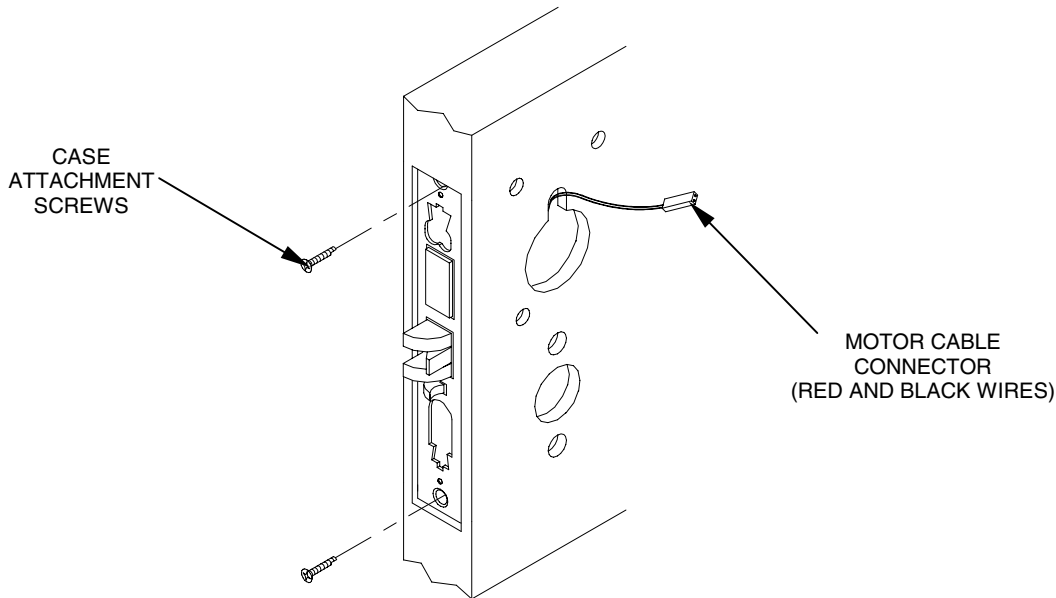

4-2 ATTACH THE TRIM

- Insert the Inner and Outer Spindle and Spring Assemblies into the Lock Hubs. Place the Outer Trim Assembly over the Outer Spindle and Spring Assembly.
- Place the Inner Insert Assembly over the Inner Spindle and Spring Assembly. Put the Screws through the Insert and thread into the Posts of the Outer Trim until tight.
- Place the Rose over the Insert, thread on the Collar and tighten with the Spanner Wrench. Place the Washer over the Outside of the Shank. Put the Inside Handle on the Shank, and as you are pressing toward the Door, tighten the Set Screw in the Handle until tight.
- Install the Thumb Turn if required.

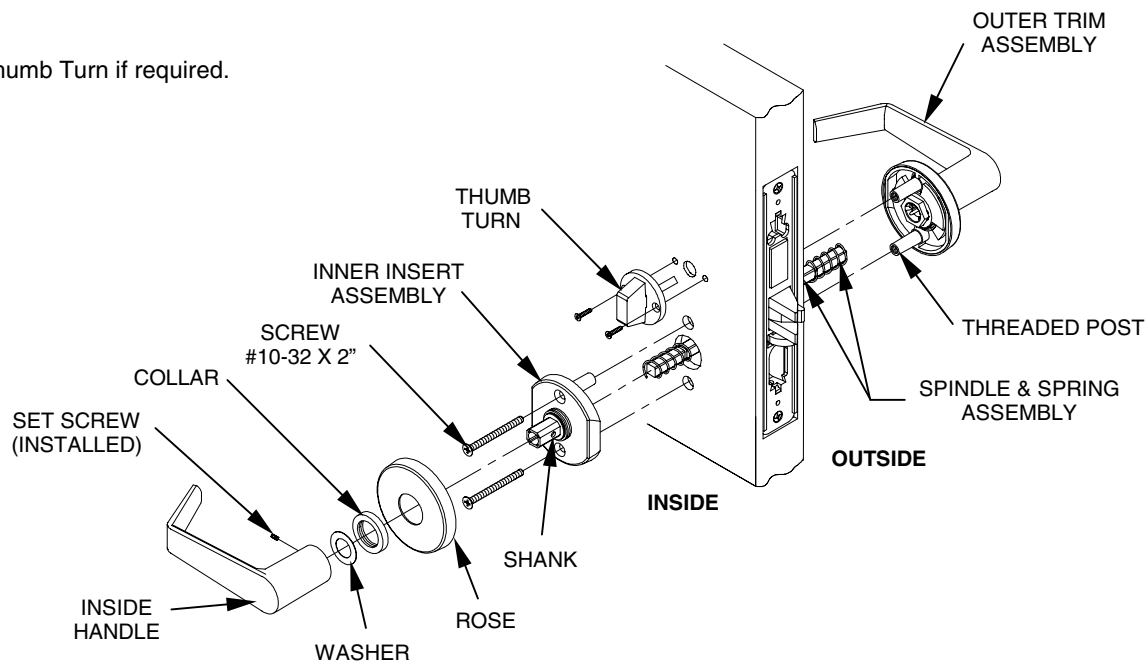

4-3 INSTALL THE ELECTRONICS MODULE

- Guide the Connectors through the front hole in the Module and place the Module against the Door so that the Standoffs and the Grounding Spring enter their respective holes.
- Install the mounting Screws and Washers finger tight.
- Connect the Motor Connector (Red and Black Wires) to the Module Connector so that the Wire colors match.
- Insert the Cables and the Connectors into the Module so that they are clear of the Cylinder Hole.

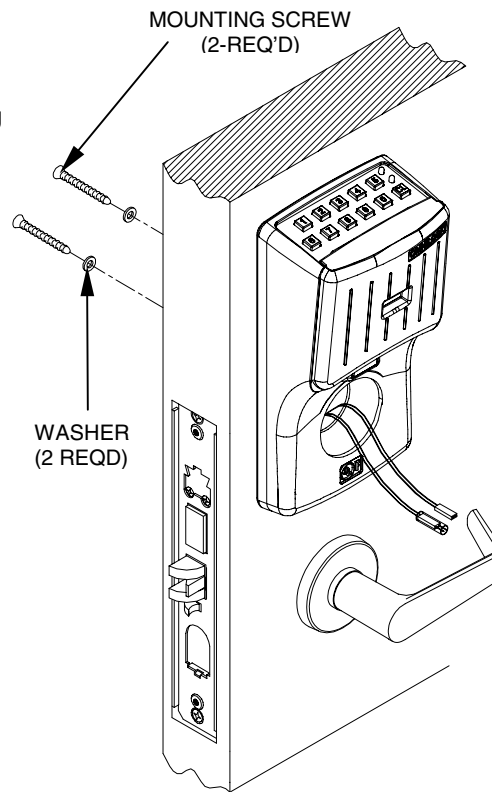

4-4 INSTALL THE CYLINDER

- Insert the Cylinder with the Wavy Washer and Collar into the Module and partially screw it into the Lock
- Tighten the Module Mounting Screws and then tighten the Cylinder until it is snug with the keyway at the bottom.
- Tighten the Cylinder Retaining Screw and install the Face Plate.
- Repeat Steps 1b and 1c, to verify operation.

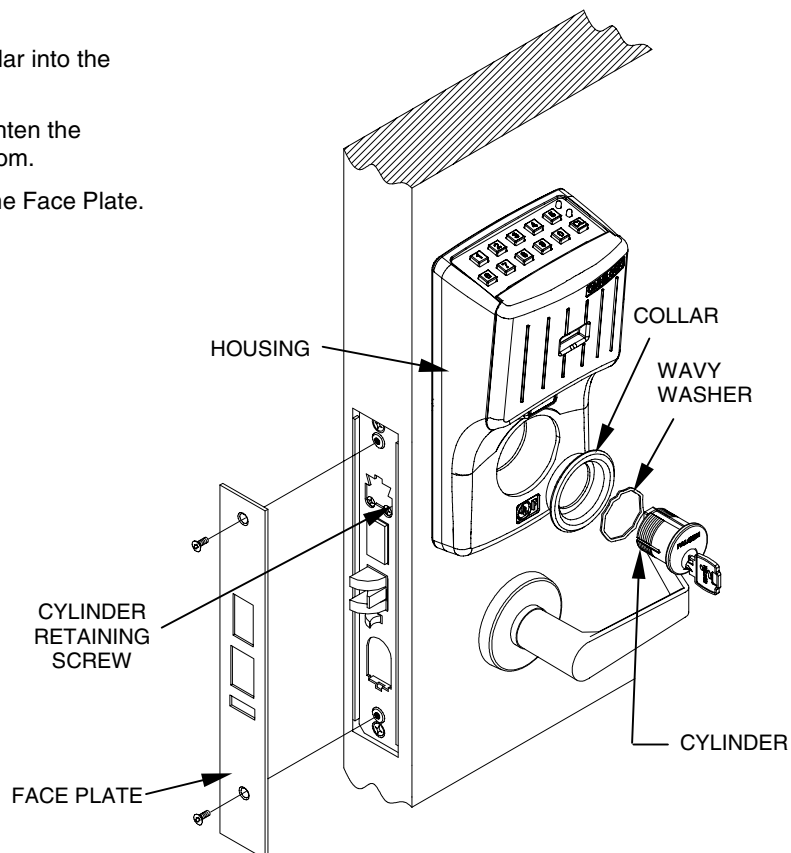

SECTION 5: INSTALL THE STRIKE

- Draw a vertical line on the Door Frame 1/2 the Door thickness from the Door Stop.

CAUTION: Allow for paint buildup or weather stripping if required.

- Select the Strike with the proper hand condition and align the bottom edge of the Strike Lip with the mark on the Door Frame and align the center of the mounting holes in the Strike with the vertical line on the frame. Using the Strike as a template, mark the Door Frame.
- Using the Strike Box as a template, mark the Door Frame.
- Mortise the Frame to accept the Strike and Strike Box.
- Install the Strike Box and the Strike and secure with the Screws.

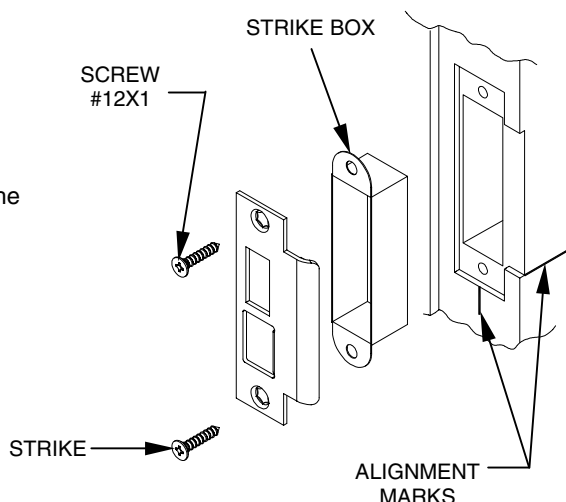

SECTION 6: PROGRAM THE LOCK SET

IMPORTANT: To avoid unauthorized access, it is important to program a new Programmer ID.

Refer to the OMNILOCK Administrator's Guide for programming instructions. If the System has been installed on a door before the required programming information is available, and your system has a keypad, the access Level may be set to Unlocked as follows:

- Enter the Default Manager ID **2 2 2 2**, at the keypad, the green light will flash.
- Press **2**, the green light will flash.
- Press and hold the **CL** key until the green light flashes four times. (The light will flash once when the **CL** key is pressed, continue to hold the key until the light flashes three more times.)
- The System will remain in the Unlocked mode.

SECTION 6: REMOTE SWITCH

- Remote operation of the System may be accomplished by a momentary Switch closure. This may be desirable for someone monitoring a protected entrance, such as a receptionist. Momentarily pressing the Switch will cause the System to go through a normal unlock and lock sequence. If the Switch is held closed, the open time will be extended.
- Connect a **twisted pair** of wires from the Terminal Block on the PC Board to a normally open momentary contact Switch. Plan the route for your wire and the access route through the door to the PC Board in the OMNILOCK Module. Plan for disconnecting the wires in the Module area so that the System can be removed from the door to change the Batteries as required.

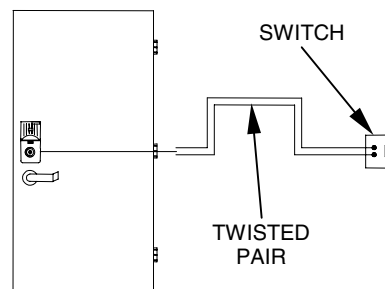

INSTALLER NOTES: Leave these instructions and other Documents with the User.